

Flange Ball Plunger Screw

The Ball sinks when the load is added to the ball.
The function is same like ball plunger set screw, it just increase flang.

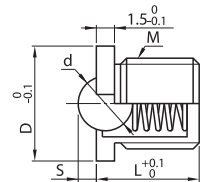
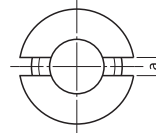

To ensure the accuracy high position to hold on the work piece.

Body SUS303, Ball SUS440C, Spring SUS631J1			Body S45C(HRC29~35) Black Oxide, Ball SUS440C, Spring SUS631J1			M	D	L	S	L	d	a
Number	Price ₪	Load(N)	Number	Price ₪	Load(N)							
469M 5812	---	1.3- 6.4	569M 5812	---	0.6- 5.6	M5 x 0.8	7	5	0.8	5	3	0.8
469M 5813	---	2.7- 8.0	569M 5813	---	2.8- 6.3	M6 x 1.0	8	6	1	6	4	1
469M 5814	---	1.3- 10.2	569M 5814	---	2.9- 9.6	M8 x 1.25	10	7	1.6	7	5	1.5
469M 5815	---	6.1-17.2	569M 5815	---	6.4-11.7	M10 x 1.5	12	9	1.9	9	6.35	1.5
469M 5816	---	2.1-18.8	569M 5816	---	9.0-15.0	M12 x 1.75	14	11.5	2.4	11.5	7.94	1.5
469M 5817	---	13.0-25.5	569M 5817	---	9.9-21.5	M16 x 2.0	18	16	3.2	16	9.53	2

Press Fit Ball Plunger



Press fit ball plungers can be used when a threaded ball plunger is impractical or when threaded adjustments are not required for detent. Easy installation for use in wood, soft plastic, or aluminum. Stainless bodies are made of 303 material. Balls are 440 stainless. Steel bodies are made of 12L14 material with a black oxide finish. Available in six popular body diameters with three convenient spring pressures.

Press Fit Ball Plunger with Stainless Ball

Steel			Stainless Steel			End Pressure Pounds		Ball Dia.					
Number	Price ₪	Mfr's	Number	Price ₪	Mfr's	Start	Full	A	B	C	D	E	F
Heavy Pressure													
3123 V541	---	10401	1123 V543	---	10421	2	5	0.188	0.405	0.085	0.156	0.250	0.035
3124 V541	---	10402	1124 V544	---	10422	3	7	0.250	0.481	0.070	0.187	0.312	0.044
3125 V541	---	10403	1125 V545	---	10423	5	14	0.375	0.785	0.110	0.312	0.500	0.078
3126 V541	---	10404	1126 V546	---	10424	8	18	0.500	1.130	0.161	0.437	0.688	0.088

Light Pressure

4123 V541	---	10411	2123 V543	---	10431	1	2.5	0.188	0.405	0.085	0.156	0.250	0.035
4124 V541	---	10412	2124 V544	---	10432	1.5	3.5	0.250	0.481	0.070	0.187	0.312	0.044
4125 V541	---	10413	2125 V545	---	10433	2.5	7	0.375	0.785	0.110	0.312	0.500	0.078
4126 V541	---	10414	2126 V546	---	10434	4	9	0.500	1.130	0.161	0.437	0.688	0.088

Press Fit Ball Plunger with Delrin® Ball Noses

Steel			Stainless Steel			End Pressure Pounds		Ball Dia.						
Number	Price ₪	Mfr's	Number	Price ₪	Mfr's	Start	Full	A	B	C	D	E	F	Net. lbs. Per 100
Heavy Pressure														
5123 V541	---	10441	6123 V541	---	10461	2	5	0.188	0.405	0.085	0.156	0.250	0.035	1/4
5124 V541	---	10442	6124 V541	---	10462	3	7	0.250	0.481	0.070	0.187	0.312	0.044	1/2
5125 V541	---	10443	6125 V541	---	10463	5	14	0.375	0.785	0.110	0.312	0.500	0.078	2
5126 V541	---	10444	6126 V541	---	10464	8	18	0.500	1.130	0.161	0.437	0.688	0.088	4

Light Pressure

7123 V541	---	10451	8123 V541	---	10471	1	2.5	0.188	0.405	0.085	0.156	0.250	0.035	1/4
7124 V541	---	10452	8124 V541	---	10472	1.5	3.5	0.250	0.481	0.070	0.187	0.312	0.044	1/2
7125 V541	---	10453	8125 V541	---	10473	2.5	7	0.375	0.785	0.110	0.312	0.500	0.078	2
7126 V541	---	10454	8126 V541	---	10474	4	9	0.500	1.130	0.161	0.437	0.688	0.088	4