

External Retaining Rings

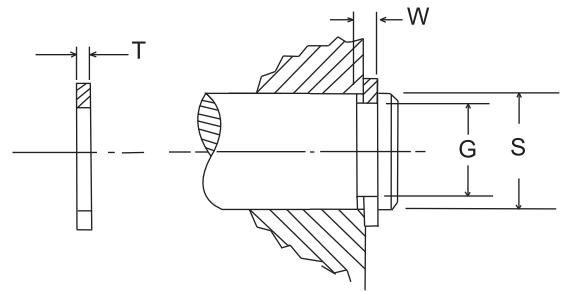
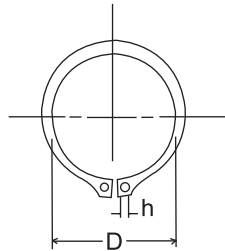

These Rings expand to pass over a shaft. When released they spring into the groove. All steel rings are made of C1060-C1090 steel. Rockwell hardness is C47-C52. Tensile strength is 90,000 psi. Stainless steel rings are made of type PH 15-7 MO stainless steel. Rockwell hardness is C44-C51. Tensile strength is 225,000 psi.

For Shaft Dia. (S)	Groove		Ring		h	Black - Phosphate Steel		Stainless Steel	
	Dia (G)	Width (W)	D	Thick (t)		Number	Price ฿	Number	Price ฿
1/8"	0.117"	0.012"	0.112"	0.010"	.024	7A63 3110	—	—	—
3/16"	0.175"	0.018"	0.168"	0.015"	.023	7A63 3120	—	—	—
1/4"	0.230"	0.029"	0.225"	0.025"	.039	7A63 3130	—	1A59 0113	—
9/32"	0.261"	0.029"	0.256"	0.025"	.039	7A63 3140	—	1A59 0112	—
5/16"	0.290"	0.029"	0.281"	0.025"	.039	7A63 3150	—	1A59 0115	—
11/32"	0.321"	0.029"	0.309"	0.025"	.039	7A63 3160	—	1A59 0116	—
3/8"	0.352"	0.029"	0.338"	0.025"	.039	7A63 3170	—	1A59 0117	—
13/32"	0.382"	0.029"	0.366"	0.025"	.039	7A63 3180	—	1A59 0118	—
7/16"	0.412"	0.029"	0.395"	0.025"	.039	7A63 3190	—	1A59 0119	—
1/2"	0.468"	0.039"	0.461"	0.035"	.045	7A63 3200	—	1A59 0122	—
9/16"	0.530"	0.039"	0.521"	0.035"	.045	7A63 3210	—	1A59 0124	—
19/32"	0.559"	0.039"	0.550"	0.035"	.045	7A63 3220	—	1A59 0125	—
5/8"	0.588"	0.039"	0.579"	0.035"	.045	7A63 3230	—	1A59 0126	—
11/16"	0.646"	0.046"	0.635"	0.042"	.050	7A63 3240	—	1A59 0127	—
3/4"	0.704"	0.046"	0.693"	0.042"	.050	7A63 3250	—	1A59 0128	—
13/16"	0.762"	0.046"	0.751"	0.042"	.050	7A63 3260	—	1A59 0129	—
7/8"	0.821"	0.046"	0.810"	0.042"	.050	7A63 3270	—	1A59 0131	—
15/16"	0.882"	0.046"	0.867"	0.042"	.076	7A63 3280	—	1A59 0132	—
63/64"	0.926"	0.046"	0.910"	0.042"	.076	7A63 3290	—	1A59 0134	—
1"	0.940"	0.046"	0.925"	0.042"	.076	7A63 3300	—	1A59 0133	—
1 1/16"	0.998"	0.056"	0.982"	0.050"	.076	7A63 3310	—	1A59 0136	—
1 1/8"	1.059"	0.056"	1.041"	0.050"	.076	7A63 3320	—	1A59 0135	—

Metric External Retaining Rings

Tensile Strength is 250,000 psi. Black - Phosphate Steel rings are made of C 1070-C1090 steel. Rockwell Hardness is C47-C54. Stainless Steel rings are made of type 420 stainless steel. Rockwell Hardness is C50, conform to JIS B2804.

For Shaft Dia. (S)	Groove		Ring		h	Black-Phosphate Steel		Stainless	
	Dia (G)	Width (W)	D	Thick (t)		Number	Price ฿	Number	Price ฿
3	2.80	0.50	2.7	0.40	1.0	8A54 1111	—	—	—
4	3.80	0.50	3.7	0.40	1.0	8A54 1112	—	—	—
5	4.80	0.70	4.7	0.60	1.0	8A54 1113	—	—	—
6	5.70	0.80	5.6	0.70	1.1	8A54 1114	—	0A96 7110	—
7	6.70	0.90	6.5	0.80	1.2	8A54 1115	—	0A96 7115	—
8	7.60	0.90	7.4	0.80	1.2	8A54 1116	—	0A96 7120	—
9	8.60	1.10	8.4	1.00	1.2	8A54 1117	—	0A96 7155	—
10	9.60	1.10	9.3	1.00	1.5	8A54 1118	—	0A96 7160	—
12	11.50	1.10	11.0	1.00	1.7	8A54 1119	—	0A96 7165	—
13	12.40	1.10	11.9	1.00	1.7	8A54 1405	—	0A96 7170	—
14	13.40	1.10	12.9	1.00	1.7	8A54 1120	—	0A96 7175	—
15	14.30	1.10	13.8	1.00	1.7	8A54 1410	—	0A96 7180	—
16	15.20	1.10	14.7	1.00	1.7	8A54 1121	—	0A96 7205	—
17	16.20	1.10	15.7	1.00	1.7	8A54 1420	—	0A96 7210	—
18	17.00	1.30	16.5	1.20	2.0	8A54 1122	—	0A96 7220	—
19	18.00	1.30	17.5	1.20	2.0	8A54 1430	—	0A96 7225	—
20	19.00	1.30	18.5	1.20	2.0	8A54 1123	—	0A96 7235	—
24	22.90	1.30	22.2	1.20	2.0	8A54 1125	—	0A96 7265	—
25	23.90	1.30	23.2	1.20	2.0	8A54 1440	—	0A96 7270	—