

Neverlub Bushing Style Cam Followers

Dimensionally Interchangeable with needle bearing cam followers. Utilizes a sintered bronze bushing as the bearing element. Built in lubrication reservoir keeps rollers permanently lubricated. Install where lubrication is difficult or impossible. No internal elements offer trouble free operation in situations subject to frequent wash down or exceptionally dusty environments. Temperature Range -1° C to 68° C.

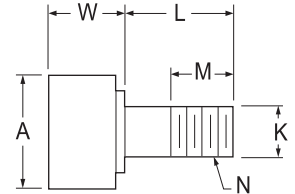

Roller Dia. (In.) A	Roller W (In.) W	Thread Sz. Class 2A N	Stud Dia. (In.) K	Stud L (In.) L	Thread L (In.) M	Dynamic Load Cap. (lbs.)	Number	Price ฿
1/2"	0.3750	10-32	3/16"	5/8"	1/4"	544	5E61 2187	—
3/4"	0.5000	3/8"-24	3/8"	7/8"	3/8"	1328	5E61 2195	—
7/8"	0.5000	3/8"-24	3/8"	7/8"	3/8"	1328	5E61 2203	—
1"	0.6250	7/16"-20	7/16"	1"	1/2"	1780	5E61 2211	—
1 1/8"	0.6250	7/16"-20	7/16"	1"	1/2"	1780	5E61 2229	—
1 1/4"	0.7500	1/2"-20	1/2"	1 1/4"	5/8"	3144	5E61 2237	—
1 3/8"	0.7500	1/2"-20	1/2"	1 1/4"	5/8"	3144	5E61 2245	—
1 1/2"	0.8750	5/8"-18	5/8"	1 1/2"	3/4"	3872	5E61 2252	—
1 3/4"	1.0000	3/4"-16	3/4"	1 3/4"	7/8"	5108	5E61 2260	—
2"	1.125	7/8"-14	7/8"	2"	1"	6472	5E61 2278	—



Cam Followers - Needle Bearing Design

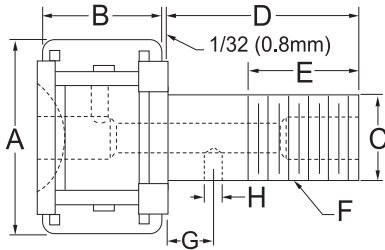

Anti - Friction cam followers are used in applications where loads and shock are moderate. The high - carbon chrome needle bearing rollers with thick outer race design permits a heavy load rating in a small package.

The inner race is made of low - carbon alloy steel. Stud followers come with threaded stud and have lubrication holes at both ends.

Stud Cam Followers - Inch Sizes

Roller Dia. (In.) A	Roller Width (In.) B	Stud Length (In.) D	Thread F	Stud Dia. (In.) C	Slotted Unsealed			Slotted Sealed			Stainless Steel		
					Dyn. Load Cap. (lbs.)	Number	Price ฿	Dyn. Load Cap. (lbs.)	Number	Price ฿	Dyn. Load Cap. (lbs.)	Number	Price ฿
1/2"	0.3750	0.625	10-32	0.1900	680	3T67 0404	—	680	3T67 0545	—	544	8T07 1673	—
5/8"	0.4375	0.750	1/4"-28	0.2500	940	3T67 0412	—	940	3T67 0552	—	796	8T07 1681	—
3/4"	0.5000	0.875	3/8"-24	0.3750	1540	3T67 0420	—	1540	3T67 0560	—	1328	8T07 1699	—
7/8"	0.5000	0.875	3/8"-24	0.3750	1540	3T67 0438	—	1540	3T67 0578	—	1328	8T07 1707	—
1"	0.6250	1.000	7/16"-20	0.4375	2190	3T67 0446	—	2190	3T67 0586	—	1780	8T07 1715	—
1 1/8"	0.6250	1.000	7/16"-20	0.4375	2190	3T67 0453	—	2190	3T67 0594	—	1780	8T07 1723	—
1 1/4"	0.7500	1.250	1/2"-20	0.5000	3390	3T67 0461	—	3390	3T67 0602	—	3144	8T07 1731	—
1 3/8"	0.7500	1.250	1/2"-20	0.5000	3390	3T67 0479	—	3390	3T67 0610	—	3144	8T07 1749	—
1 1/2"	0.8750	1.500	5/8"-18	0.6250	4450	3T67 0487	—	4450	3T67 0628	—	3872	8T07 1756	—
1 5/8"	0.8750	1.500	5/8"-18	0.6250	4450	3T67 0495	—	4450	3T67 0636	—	—	—	—
1 3/4"	1.0000	1.750	3/4"-16	0.7500	6070	3T67 0503	—	6070	3T67 0644	—	5108	8T07 1764	—
1 7/8"	1.0000	1.750	3/4"-16	0.7500	6070	3T67 0511	—	6070	3T67 0651	—	—	—	—
2"	1.2500	2.000	7/8"-14	0.8750	8010	3T67 0529	—	8010	3T67 0669	—	6472	8T07 1772	—
2 1/4"	1.2500	2.000	7/8"-14	0.8750	8010	3T67 0537	—	8010	3T67 0677	—	—	—	—

Stud cam followers - Metric sizes

Roller Dia. (mm) A	Roller Width (mm) B	Stud Length (mm) D	Thread F	Stud Dia. (mm) C	Slotted Unsealed			Slotted Sealed		
					Dynamic Load Cap. (lbs.)	Number	Price ฿	Dynamic Load Cap. (lbs.)	Number	Price ฿
16	11	28	M6	6	3800	3T67 0826	—	6400	3T67 0891	—
19	11	32	M8	8	4250	3T67 0834	—	7300	3T67 0909	—
22	12	36	M10X1	10	5700	3T67 0842	—	8600	3T67 0917	—
26	12	36	M10X1	10	5700	3T67 0859	—	8600	3T67 0925	—
30	14	40	M12X1.5	12	8100	3T67 0867	—	12200	3T67 0933	—
35	18	52	M16X1.5	16	12900	3T67 0875	—	18300	3T67 0941	—
40	20	58	M18X1.5	18	14200	3T67 0883	—	21000	3T67 0958	—