

High Precision Standard Single Universal Joint

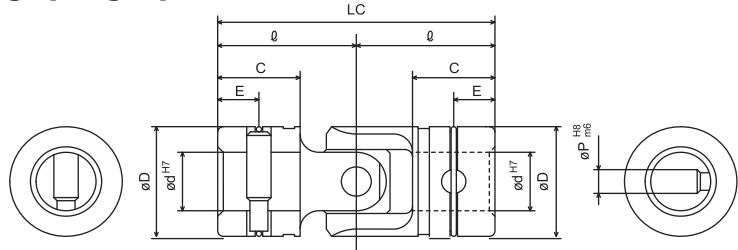

Shape 00 Fig. 1

(3 to 50mm Diam.) Accessories heavy duty set pin 2 pcs.
Ring spring 2 pcs.



Universal joint or is used to connect two sprinning shaft that are not aligned.
To Choose a U-joint, Consider the angle of the Shafts as well as the Speed (rpm) and torque the joint will need to transmit.

Shape 03 Fig. 2

(6 to 50mm Diam.) Accessories heavy duty set pin 1 pcs.
Ring spring 1 pcs.

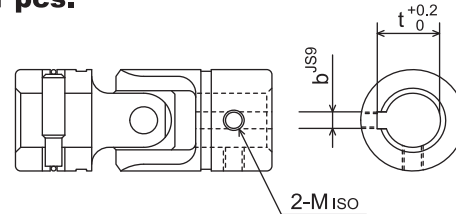

Generally the more the shafts are offset, The less speed and torque the U-joint will be able to transmit.

Single U-joints compensate for angular offset only. Double U-joints compensate for angular and parallel offset.

To Order please specify configuration shape in square block
Exsample 1P02712000A = Ø 12 mm Heavy duty set P/N 2 Pes
Ring spring 2 Pec (Fig. 1) Universal joint.

Shape 33 Fig. 3

(New JIs Key) (6 to 50mm Diam.)

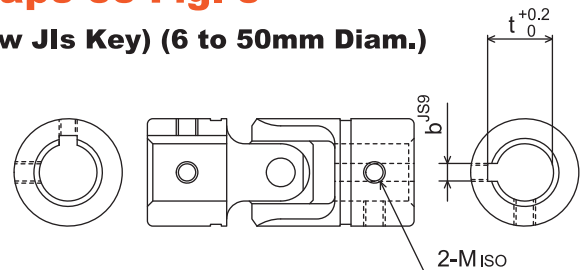

Angle	5° and Under	10°	15°	20°	25°	30°
Angle Coefficient	1.00	1.05	1.18	1.43	1.82	2.50

Single U-Joint
Angular Offset

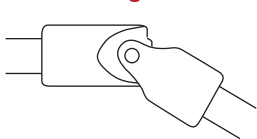

Double U-Joint
Parallel Offset

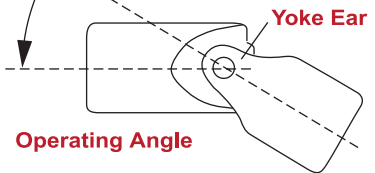
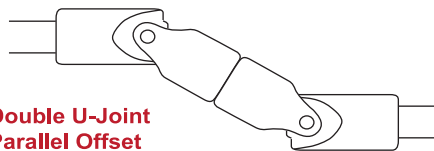

Number	Dimension													Allowable Operating Angle(°)	Allowable Torque(N.m)	Weight (g)
	d	D	LC	l	C	E	P	b	t	b8	t8	M	KC			
1P02 7120 00A	3	6	26	13	9	2.5	1	—	—	—	—	—	—	30	0.13	5
1P02 7121 00A	4	8	24	12	7	4	1.5	—	—	—	—	—	—	30	0.96	8
1P02 7122 00A	5	10	30	15	9	5	2	—	—	—	—	—	—	30	3.23	12
1P02 7123 □□ A	6	12	31	15.5	9	4.5	3	—	—	—	—	3	—	30	5.3	15
1P02 7124 □□ A	8	15	36	18	10	5	3.5	—	—	—	—	3	25	30	11.6	30
1P02 7125 □□ A	10	19	42	21	12	6	4.5	3	11.4	4	11.5	5	32	30	27.4	55
1P02 7126 □□ A	12	23	52	26	15	7.5	5	4	13.8	4	13.5	5	35	30	46	110
1P02 7127 □□ A	14	26	59	29.5	17	8.5	5.8	5	16.3	5	16	6	40	30	66	155
1P02 7128 □□ A	16	30	74	37	22	11	6.5	5	18.3	5	18	6	46	30	102	260
1P02 7129 □□ A	18	33	81	40.5	23.5	11.75	7	6	20.8	5	20	6	52	30	132	345
1P02 7130 □□ A	20	36	87	43.5	25	12.5	8	6	22.8	5	22	6	58	30	175	465
1P02 7131 □□ A	22	40	94	47	27	13.5	9	6	24.8	7	25	6	62	30	251	630
1P02 7132 □□ A	25	44	105	52.5	30	15	10	8	28.3	7	28	8	68	30	330	790
1P02 7133 □□ A	30	51	122	61	35	17.5	11.5	8	33.3	7	33	8	82	30	495	1160