

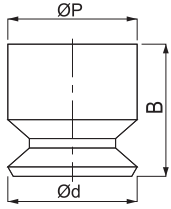

Vacuum Pad Standard Type (Economy Type)

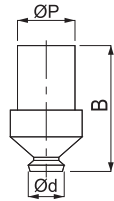

Pad Dia. 6, 8, 10 mm



Pad Dia. 2-4 mm

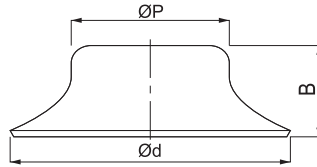

Pad Dia. 15-20 mm



Number	Price ฿	Mfr's	NBR		Silicon Rubber		ESD Conductive Silicon Rubber		Pad dia. Ød	B	ØP
			Number	Price ฿	Number	Price ฿	Number	Price ฿			
5V30 8547	—	VP 2R	6V30 9547	—	8V30 9547	—	7V30 9547	—	2	8	3.2
5V30 8548	—	VP 3R	6V30 9548	—	8V30 9548	—	7V30 9548	—	3	8	3.2
5V30 8549	—	VP 4R	6V30 9549	—	8V30 9549	—	7V30 9549	—	4	8	3.2
5V30 8550	—	VP 6R	6V30 9550	—	8V30 9550	—	7V30 9550	—	6	7	6
5V30 8551	—	VP 8R	6V30 9551	—	8V30 9551	—	7V30 9551	—	8	5.5	6
5V30 8552	—	VP 10R	6V30 9552	—	8V30 9552	—	7V30 9552	—	10	8	10
5V30 8553	—	VP 15R(A)	6V30 9553	—	8V30 9553	—	7V30 9553	—	15	9(10)	11
5V30 8554	—	VP 20R(A)	6V30 9554	—	8V30 9554	—	7V30 9554	—	20	10(11)	15

Flat Cups

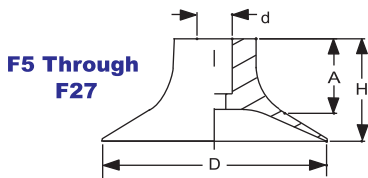

F5 Through F27

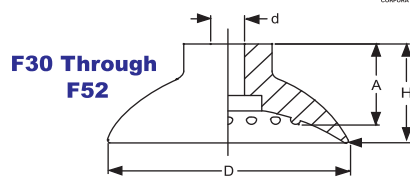

F30 Through F52



Flat cups attach quickly due to the small volume of air to be evacuated. They feature patterned knobs on the bottom to prevent sticking and are excellent for holding flat, Flexible materials without deformation.

Relatively stiff, The cup bodies retain their shape well in production applications. They are excellent on fast cycle transfer systems. Use on flat or slightly curved surfaces and for horizontal or vertical lifting.

Number	Price ฿	Mfr's Cup No.	NBR		Silicon		Fitting Type	D Dia.		d Dia.		H		A **		Capacity	
			Number	Price ฿	Number	Price ฿		In.	mm	In.	mm	In.	mm	In.	mm	lbs.	kg.
6F70 9877	—	F5	7F77 9877	—	8F27 9877	—	1	0.20	5	0.16	4	0.36	9	0.32	8.0	0.02	0.07
6F70 9878	—	F10	7F77 9878	—	8F27 9878	—	1	0.39	10	0.20	5	0.43	11	0.37	9.4	0.60	0.3
6F70 9879	—	F15	7F77 9879	—	8F27 9879	—	1	0.59	15	0.20	5	0.44	11.2	0.36	9.1	1.40	0.6
6F70 9880	—	F20	7F77 9880	—	8F27 9880	—	1	0.79	20	0.20	5	0.45	11.5	0.33	8.5	2.20	1.0
6F70 9881	—	F25	7F77 9881	—	8F27 9881	—	1	1.00	25	0.20	5	0.50	12.5	0.38	9.7	3.10	1.4
6F70 9882	—	F27	7F77 9882	—	8F27 9882	—	1	1.06	27	0.17	4	0.51	13	0.35	9	4.00	1.8
6F70 9883	—	F30	7F77 9883	—	8F27 9883	—	2	1.20	30	0.31	8	0.76	19	0.63	16.0	4.90	2.2
6F70 9884	—	F35	7F77 9884	—	8F27 9884	—	2	1.42	36	0.31	8	0.79	20	0.63	16.0	7.00	3.2
6F70 9885	—	F40	7F77 9885	—	8F27 9885	—	2	1.60	40	0.31	8	0.79	20	0.63	16.0	9.50	4.3
6F70 9886	—	F52	7F77 9886	—	8F27 9886	—	2	2.05	52	0.31	8	0.87	22	0.69	17.5	15.10	6.8

** A = Attached height

Vacuum Cup Fitting

Type 1 Push-On-Barb Style Fittings with a shank Diameter of 0.20 Inches (5 mm.)

Number	Price ฿	Mfr's	Connection Thread Size	Wrench Size	L - Added to Assy. Height		Thru Hole Diameter	
					in.	mm	In.	mm
5Q96 1278	—	B18F	1/8" NPT female	14mm	0.47	12	0.13	3.4
5Q96 1279	—	BM10-32	10-32 UNF male	7mm	0.2	5	0.09	2.3
5Q96 1280	—	BM5	M5 (5 mm) male	7mm	0.2	5	0.09	2.3
5Q96 1281	—	BM6	M6 (5 mm) male	7mm	0.2	5	0.13	3.4
5Q96 1282	—	B18M	1/8" NPT male	14mm	0.24	6	0.13	3.4

