

Linear Way

Linear Way (Wide Rail Type)



Linear Way is a miniature type linear motion rolling guide incorporating two rows of steel balls arranged in four - point contact with the raceways. Owing to its simple design it provides stable accuracy and rigidity even in operations under fluctuating loads with changing direction and magnitude or complex loads. Black and Rail come in assembly set.

IKO

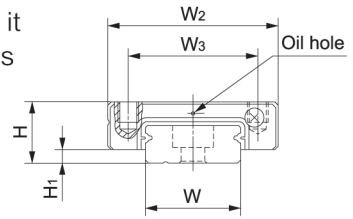

To order please provides rail length and total of blocks in set.

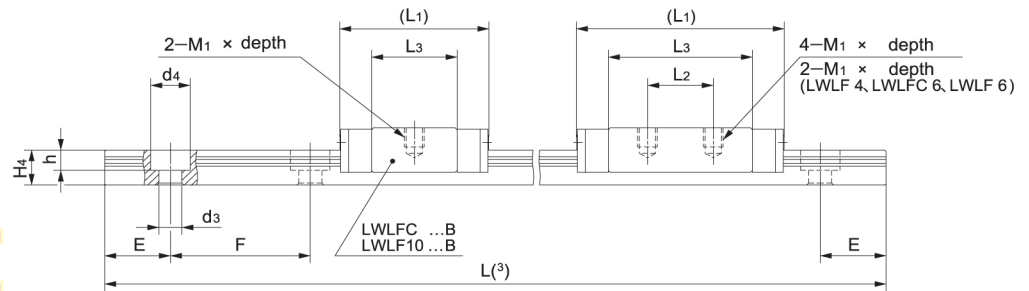

Metric Dimension

Block		Rail (Price/10mm)		Mass (Ref.) g		Dia. of Assembly mm		Dimensions of Slide Unit mm						Dimensions of Track Rail mm						
Number	Price ฿	Number	Price ฿	Slide Unit	Track Rail (per 100 mm)	H	H ₁	W ₂	W ₃	L ₁	L ₂	L ₃	M ₁ x Depth	W	H ₄	d ₃	d ₄	h	E	F
7L65 9911	---	7L66 9911	---	2.1	6.8	4	1	10	---	17	6.5	11.9	M2 x 1.3	4	2.6	1.8	2.8	0.75	5	10
7L65 9912	---	7L66 9912	---	2.4	13	4.5	1	12	---	15	4.5	9.8	M2 x 1.6	6	2.8	2.4	4	1.5	7.5	15
7L65 9913	---	7L66 9913	---	12	M3											---				
7L65 9914	---	7L66 9914	---	3.4	13	6.5	1.5	17	13	20	8	14.6	M2.5 x 1.5	10	4	2.4	4	1.5	10	20
7L65 9915	---	7L66 9915	---	12	M3											---				
7L65 9916	---	7L66 9916	---	5.9	28	9	2	25	19	20.5	---	13.6	M3 x 3	14	5.5	2.9	4.8	1.6	15	30
7L65 9917	---	7L66 9917	---	29	M3											---				
7L65 9918	---	7L66 9918	---	28	2.9											4.8	1.6			
7L65 9919	---	7L66 9919	---	7.5	29	12	3	30	21	24.5	17.6	M2.6 x 3	18	7	M3	---	---	15	30	
7L65 9920	---	7L66 9920	---	13	3.5										6	3.2				
7L65 9921	---	7L66 9921	---	21	54	14	5.2	31.5	10	21.9	M2.6 x 3	7.5	3.5	6.5	4.5	M4	---	---	20	40
7L65 9922	---	7L66 9922	---	56	M4											---				
7L65 9923	---	7L66 9923	---	56	M4											---				
7L65 9924	---	7L66 9924	---	31	54	12	3	30	23	50.5	24	40.4	M3 x 3	18	7	3.5	6	3.2	15	30
7L65 9925	---	7L66 9925	---	56	M4											---				
7L65 9926	---	7L66 9926	---	23	53	14	3	40	28	31.5	---	17.7	M3 x 3.5	24	8	3.5	6	3.2	20	40
7L65 9927	---	7L66 9927	---	90	M4											---				
7L65 9928	---	7L66 9928	---	26	92	14	3	40	28	59	28	46.3	M3 x 3	24	8.5	3.5	6.5	4.5	20	40
7L65 9929	---	7L66 9929	---	90	M4											---				
7L65 9930	---	7L66 9930	---	44	90	14	3	40	28	44	15	31	M3 x 3	24	8.5	3.5	6.5	4.5	20	40
7L65 9931	---	7L66 9931	---	92	M4											---				
7L65 9932	---	7L66 9932	---	61	90	14	3	40	28	59	28	46.3	M3 x 3	24	8.5	3.5	6.5	4.5	20	40
7L65 9933	---	7L66 9933	---	92	M4											---				
7L65 9934	---	7L66 9934	---	39	98	14	3	40	28	44	15	31	M3 x 3	24	8.5	3.5	6.5	4.5	20	40
7L65 9935	---	7L66 9935	---	98	M4											---				
7L65 9936	---	7L66 9936	---	45	139	14	3	40	28	44	15	31	M3 x 3	24	8.5	3.5	6.5	4.5	20	40
7L65 9937	---	7L66 9937	---	76	M4											---				
7L65 9938	---	7L66 9938	---	111	150	14	3	40	28	44	15	31	M3 x 3	24	8.5	3.5	6.5	4.5	20	40
7L65 9939	---	7L66 9939	---	74	M4											---				
7L65 9940	---	7L66 9940	---	74	150	14	3	40	28	44	15	31	M3 x 3	24	8.5	3.5	6.5	4.5	20	40
7L65 9940	---	7L66 9940	---	74	M4											---				

(Continued on following page)